

NOTES: See Tabulated Sheet

- 1 Relief permits component shafts to near butt.
- 2 Hubs and flexing elements are made from a single piece of material.
- 3 Set Screw attachment, hex socket, ISO std., cup point set screw furnished: both hubs.
- 4 Backlash: None. No lubrication required.
- 5 Permitted axial motion from free length:  $\pm 0.10\text{mm}$ .
- 6 RPM: Up to 10,000, depending upon application.
- 7 Working torque: 0.20Nm
- 8 Torsional stiffness: 2.3 deg/Nm
- 9 Permissible shaft misalignment: Angular, up to 1 degree.

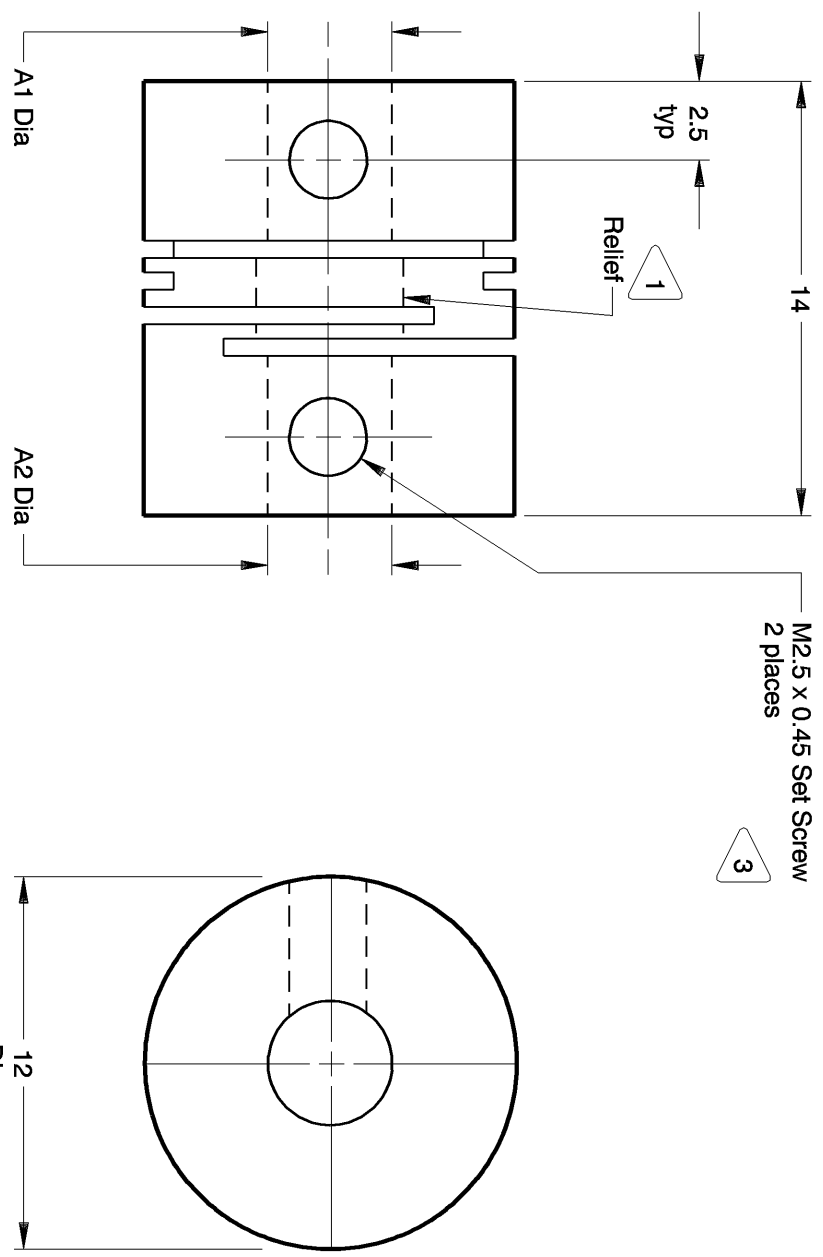

**XAS12-4mm-4mm SHOWN**

NOTICE: THE INFORMATION AND DATA CONTAINED HEREIN IS CONSIDERED PROPRIETARY TO HELICAL PRODUCTS COMPANY, INC., AND SHALL REMAIN THE EXCLUSIVE PROPERTY OF HELICAL. THE HOLDER WILL ASSUME CUSTODY AND CONTROL THAT THIS DOCUMENT WILL NOT BE COPIED, REPRODUCED OR DISCLOSED WITHOUT THE WRITTEN PERMISSION OF HELICAL. THIS DOCUMENT DOES NOT CONSTITUTE A GRANT TO MANUFACTURE ANY ITEMS. DO NOT SCALE DRAWING.

DATE	LTR	REVISION	CHK	UNLESS OTHERWISE NOTED DIMENSIONS IN MILLIMETERS.	APPROVALS	DATE	TITLE
				Tolerances are: Decimals: X $\pm .5\text{mm}$ X.X $\pm .25\text{mm}$ X.XX $\pm .15\text{mm}$ Angles: $\pm 2$ degrees Break sharp corners .25mm max.	DRAWN <b>DRW</b>	<b>9-6-02</b>	<b>HELICAL PRODUCTS CO., INC.</b> P.O. BOX 1069 SANTA MARIA, CA. 93456 U.S.A PHONE (805) 928-3851 FSC13201
					CHECKED <b>MC</b>	<b>10-3-02</b>	
					PRODN <b>DH</b>	<b>10-3-02</b>	
					ISSUED		MATERIAL <b>7075-T6 Aluminum Alloy</b>
					WEIGHT <b>3.2g (calc)</b>		FINISH <b>Anodize</b>
					SCALE <b>4/1</b>	SIZE <b>A</b>	DWG NO <b>XAS12</b>

ADDITION DATE	PART NUMBER	BORE TOLERANCES		COMMENTS	ADDITION DATE	PART NUMBER	BORE TOLERANCES		COMMENTS
		A1 Dia	A2 Dia				A1 Dia	A2 Dia	
6 SEP 02	XAS12-4mm-4mm	4.00mm	4.00mm						
6 SEP 02	XAS12-5mm-5mm	5.00mm	5.00mm						

NOTICE: THE INFORMATION AND DATA CONTAINED HEREIN IS CONSIDERED PROPRIETARY TO HELICAL PRODUCTS COMPANY, INC., AND SHALL REMAIN THE EXCLUSIVE PROPERTY OF HELICAL. THE HOLDER WILL ASSUME CUSTODY AND CONTROL THAT THIS DOCUMENT WILL NOT BE COPIED, REPRODUCED OR DISCLOSED WITHOUT THE EXPRESS WRITTEN CONSENT OF HELICAL. POSSESSION OF THIS DOCUMENT DOES NOT CONSTITUTE A GRANT TO MANUFACTURE ANY ITEMS.

APPROVALS	DATE	TITLE
DRAWN <b>DRW</b>	<b>9-6-02</b>	HELICAL PRODUCTS CO. INC P.O. BOX 1069 SANTA MARIA, CA, 93456 U.S.A PHONE (805) 928-3851(FSC13201)  HELICAL FLEXIBLE SHAFT COUPLING
CHECKED <b>MC</b>	<b>10-3-02</b>	
PRODN <b>DH</b>	<b>10-3-02</b>	
ISSUED		<b>TABULATED BORE SIZES</b>
		DWG NO <b>XAS12</b>
		REV