

NOTES: See Tabulated Sheet

- 1 Relief permits component shafts to near butt.
- 2 Hubs and HELICAL FLEXURE are made from a single piece of material.
- 3 Set Screw attachment, hex. socket, ISO std., cup point set screw furnished; both hubs. Set screw size based on bore size:
 .078in thru .117in : M2x0.4
 .118in thru .136in : M2.5x0.45
 .137in thru .354in : M3x0.5
- 4 Backlash: None.
No lubrication required.
- 5 Permitted axial motion from free length: ± .25mm.
- 6 RPM: Up to 10,000, depending upon application.
- 7 Working torque ratings are based upon continuous duty with noted misalignments applied separately and may be increased with improved alignment.
See Tabulated Sheet
- 8 Permissible shaft misalignment:
Angular, up to 5 degrees.
Offset, up to .25mm.
(TIR, .50mm.)

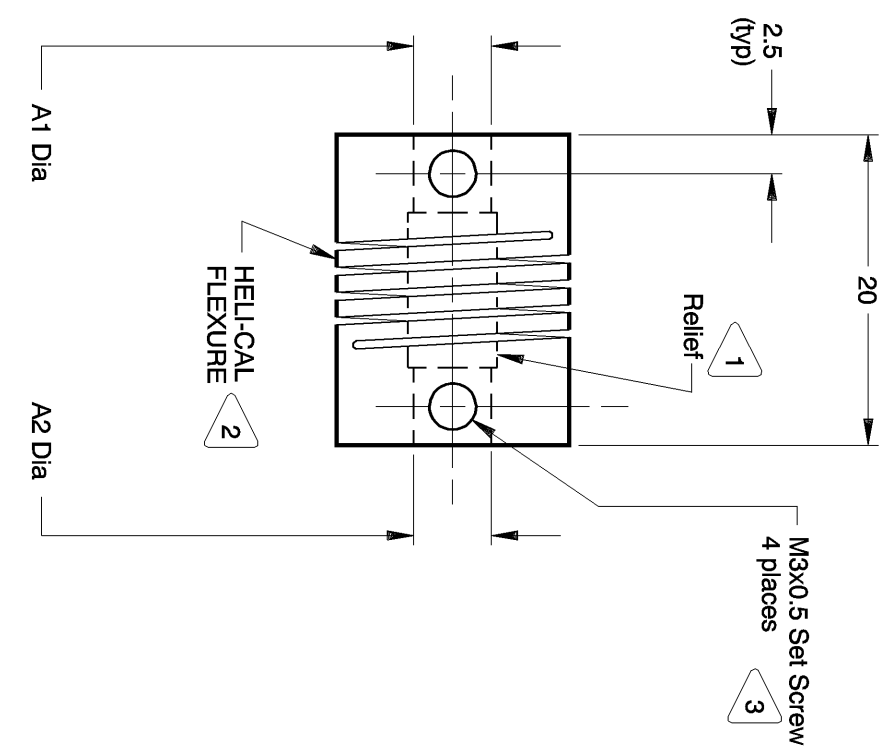

W7 15-5mm-5mm SHOWN

NOTICE: THE INFORMATION AND DATA CONTAINED HEREIN IS CONSIDERED PROPRIETARY TO HELICAL PRODUCTS COMPANY, INC., AND SHALL REMAIN THE EXCLUSIVE PROPERTY OF HELICAL PRODUCTS COMPANY. THE HOLDER WILL ASSUME CUSTOMER'S RESPONSIBILITY FOR THIS DOCUMENT WILL NOT BE COPIED, REPRODUCED OR DISCLOSED WITHOUT THE EXPRESS WRITTEN CONSENT OF HELICAL. POSSESSION OF THIS DOCUMENT DOES NOT CONSTITUTE A GRANT TO MANUFACTURE ANY ITEMS. DO NOT SCALE DRAWING.

9-14-98	DATE		LTR	Clerical format update/ No revision	REVISION	BJM	MC	CHK	Unless otherwise noted dimensions in millimeters. Tolerances are: Decimals: X ± .5mm X.X ± .25mm X.XX ± .15mm Angles: ± 2 degrees Break sharp corners .25mm max.	APPROVALS DRAWN MM 8-4-78	DATE 8-4-78	HELICAL PRODUCTS CO., INC. P.O. BOX 1069 SANTA MARIA, CA. 93456 U.S.A PHONE (805) 928-3851 FSC13201
									PROD N APA 8-4-78	TITLE HELICAL FLEXIBLE SHAFT COUPLING		
									ISSUED	MATERIAL 17-4PH CRES	FINISH Natural	
									WEIGHT 23g (calc)			
									SCALE 2/1	SIZE A	DWG NO W7 15	

ADDITION DATE	PART NUMBER	BORE TOLERANCES		TORQUES (Nm)			TORSIONAL FLEXIBILITY	MASS MOMENT OF INERTIA	COMMENTS
		A1 Dia	A2 Dia	Non-reversing	Shock or Reversing	Momentary			
09 Mar 88	W715-3mm-3mm	+0.02in -0.00in	+0.05mm -0.00mm	.70	.35	1.4			
	W715-4-3mm	.125in	3.00mm	.70	.35	1.4			
02 May 90	W715-3.8mm-3.8mm	3.80mm	3.80mm	.68	.34	1.4			
07 Jan 03	W715-5-4	.157in	.125in	.65	.33	1.3			
03 May 88	W715-4mm-3mm	4.00mm	3.00mm	.65	.33	1.3			
	W715-4mm-4M	4.00mm	.120in	.65	.33	1.3			
03 May 88	W715-4mm-4	4.00mm	.125in	.65	.33	1.3			
09 Mar 88	W715-4mm-4mm	4.00mm	4.00mm	.65	.33	1.3			
	W715-4.5mm-3mm	4.50mm	3.00mm	.65	.33	1.3			
09 Mar 88	W715-4.53mm-4M	4.53mm	.120in	.65	.33	1.3			
09 Mar 88	W715-6-4M	.188in	.120in	.65	.33	1.3			
09 Mar 88	W715-6-6	.188in	.188in	.65	.33	1.3			
31 Aug 01	W715-5mm-2mm	5.00mm	2.00mm	.60	.30	1.2			
09 Mar 88	W715-5mm-3mm	5.00mm	3.00mm	.60	.30	1.2			
	W715-5mm-4	5.00mm	.125in	.60	.30	1.2			
09 Mar 88	W715-5mm-4mm	5.00mm	4.00mm	.60	.30	1.2			
09 Dec 04	W715-5mm-4.5mm	5.00mm	4.50mm	.60	.30	1.2			
16 Apr 04	W715-5mm-6	5.00mm	.188in	.60	.30	1.2			
09 Mar 88	W715-5mm-5mm	5.00mm	5.00mm	.60	.30	1.2			
	W715-6mm-3mm	* 6.00mm	3.00mm	.60	.30	1.2			
	W715-6mm-4mm	* 6.00mm	4.00mm	.60	.30	1.2			
09 Mar 88	W715-6mm-5mm	* 6.00mm	5.00mm	.60	.30	1.2			
09 Mar 88	W715-6mm-6mm	* 6.00mm	* 6.00mm	.60	.30	1.2			
09 Mar 88	W715-8-3mm	* .250in	3.00mm	.60	.30	1.2			
09 Mar 88	W715-8-4mm	* .250in	4.00mm	.60	.30	1.2			
03 May 88	W715-8-5mm	* .250in	5.00mm	.60	.30	1.2			
	W715-8-6mm	* .250in	* 6.00mm	.60	.30	1.2			
	W715-8-8	* .250in	* .250in	.60	.30	1.2			
02 Apr 01	W715-6.4mm-6.4mm	* 6.40mm	* 6.40mm	.60	.30	1.2			
13 May 04	W715-7mm-7mm	* 7.00mm	* 7.00mm	.60	.30	1.2			
	W715-8mm-3mm	* 8.00mm	3.00mm	.60	.30	1.2			

* NOTE: Bores greater than 5.00mm Dia: bore depth is 5.00mm

NOTICE: THE INFORMATION AND DATA CONTAINED HEREIN IS CONSIDERED PROPRIETARY TO HELICAL PRODUCTS COMPANY, INC., AND SHALL REMAIN THE EXCLUSIVE PROPERTY OF HELICAL. THE HOLDER WILL ASSUME CUSTODY AND CONTROL THAT THIS DOCUMENT WILL NOT BE COPIED, REPRODUCED OR DISCLOSED WITHOUT THE EXPRESS WRITTEN CONSENT OF HELICAL. POSSESSION OF THIS DOCUMENT DOES NOT CONSTITUTE A GRANT TO MANUFACTURE ANY ITEMS.

ADDITIONAL BORE SIZES AVAILABLE UPON REQUEST

APPROVALS	DATE	HELICAL PRODUCTS CO., INC
DRAWN		P.O. BOX 1069 SANTA MARIA, CA, 93456 U.S.A
CHECKED		PHONE (805) 928-3851(FSC1320)
PRODN		TITLE HELICAL FLEXIBLE SHAFT COUPLING
ISSUED	3/30/2006 10:21:23 AM	DWG NO W715
		TABULATED BORE SIZES

ADDITION DATE	PART NUMBER	BORE TOLERANCES		TORQUES (Nm)			TORSIONAL FLEXIBILITY	MASS MOMENT OF INERTIA	COMMENTS
		A1 Dia	A2 Dia	Non-reversing	Shock or Reversing	Momentary			
16 Jun 89	W715-8mm-6mm W715-8mm-8mm	* 8.00mm * 8.00mm	* 6.00mm * 8.00mm	.60 .60	.30 .30	1.2 1.2			A1 A2

*** NOTE: Bores greater than 5.00mm Dia: bore depth is 5.00mm**

NOTICE: THE INFORMATION AND DATA CONTAINED HEREIN IS CONSIDERED PROPRIETARY TO HELICAL PRODUCTS COMPANY, INC., AND SHALL REMAIN THE EXCLUSIVE PROPERTY OF HELICAL. THE HOLDER WILL ASSUME CUSTODY AND CONTROL THAT THIS DOCUMENT WILL NOT BE COPIED, REPRODUCED OR DISCLOSED WITHOUT THE EXPRESS WRITTEN CONSENT OF HELICAL. POSSESSION OF THIS DOCUMENT DOES NOT CONSTITUTE A GRANT TO MANUFACTURE ANY ITEMS.

ADDITIONAL BORE SIZES AVAILABLE UPON REQUEST

APPROVALS	DATE	TITLE
DRAWN		HELICAL PRODUCTS CO. INC
CHECKED		P.O. BOX 1069 SANTA MARIA, CA, 93456 U.S.A
PRODN		PHONE (805) 928-3851 FSC13201
ISSUED	3/30/2006 10: 21: 23 AM	DWG NO W715

TABULATED BORE SIZES